

Plant Material List

Quantity	Trade Name	Common Name	Planting Size	Quantity	Trade Name	Common Name	Planting Size
11	008	Autumn Blue Spruce	2" x 6"	25	014	Spirea japonica (var.)	1" x 6"
5	009	Autumn Blue Spruce	4" x 6"	4	015	Flowers Yellow (var. Blue 10-14")	1" x 6"
4	010	Autumn Purple White Ash	2" x 6"	2	016	Hydrangea (var. Blue 12-14")	1" x 6"
3	011	Decorative Turkey Fern	1" x 12" x 6"	3	017	Red High Spire	1" x 6"
4	012	Hydrangea (var. Blue)	2" x 6"	10	018	Red Shrub Dogwood (var. 10" x 12")	1" x 6"
4	013	Hydrangea (var. Blue)	1" x 12" x 6"	10	019	Red Spirea	1" x 6"
10	014	Hydrangea (var. Blue)	1" x 12" x 6"	40	020	Flowers Purple (var. Blue)	1" x 6"
10	015	Red High Spire	1" x 6"	4	021	Hydrangea	1" x 6"
10	016	Red Shrub Dogwood (var. 10" x 12")	2" x 6"	10	022	White Dwarfs	1" x 6"
2	017	Red Spirea	2" x 6"	20	023	Russian Sage	1" x 6"
4	018	Flowers Yellow (var. Blue 10-14")	2" x 6"	40	024	White Sp. Red Spirea (var. 10" x 12")	1" x 6"
4	019	Hydrangea (var. Blue)	1" x 12" x 6"	4	025	White Spirea	1" x 6"
4	020	Flowers Purple (var. Blue)	1" x 12" x 6"				

Quantity	Trade Name	Common Name	Planting Size	Quantity	Trade Name	Common Name	Planting Size
6	026	Aster (var. Blue)	1" x 6"	11	031	Spirea japonica	1" x 6"
10	027	Red Spirea	1" x 6"	11	032	White Dwarfs	1" x 6"
10	028	Red Spirea	1" x 6"	4	033	Red Spirea (var. Blue 10-14")	1" x 6"
10	029	Red Spirea	1" x 6"	4	034	Red Spirea (var. Blue 10-14")	1" x 6"
10	030	Red Spirea	1" x 6"	10	035	Red Spirea (var. Blue 10-14")	1" x 6"
10	031	Red Spirea	1" x 6"	10	036	Red Spirea (var. Blue 10-14")	1" x 6"
10	032	Red Spirea	1" x 6"	10	037	Red Spirea (var. Blue 10-14")	1" x 6"
10	033	Red Spirea	1" x 6"	10	038	Red Spirea (var. Blue 10-14")	1" x 6"
10	034	Red Spirea	1" x 6"	10	039	Red Spirea (var. Blue 10-14")	1" x 6"
10	035	Red Spirea	1" x 6"	10	040	Red Spirea (var. Blue 10-14")	1" x 6"
10	036	Red Spirea	1" x 6"	10	041	Red Spirea (var. Blue 10-14")	1" x 6"
10	037	Red Spirea	1" x 6"	10	042	Red Spirea (var. Blue 10-14")	1" x 6"
10	038	Red Spirea	1" x 6"	10	043	Red Spirea (var. Blue 10-14")	1" x 6"
10	039	Red Spirea	1" x 6"	10	044	Red Spirea (var. Blue 10-14")	1" x 6"
10	040	Red Spirea	1" x 6"	10	045	Red Spirea (var. Blue 10-14")	1" x 6"
10	041	Red Spirea	1" x 6"	10	046	Red Spirea (var. Blue 10-14")	1" x 6"
10	042	Red Spirea	1" x 6"	10	047	Red Spirea (var. Blue 10-14")	1" x 6"
10	043	Red Spirea	1" x 6"	10	048	Red Spirea (var. Blue 10-14")	1" x 6"
10	044	Red Spirea	1" x 6"	10	049	Red Spirea (var. Blue 10-14")	1" x 6"
10	045	Red Spirea	1" x 6"	10	050	Red Spirea (var. Blue 10-14")	1" x 6"
10	046	Red Spirea	1" x 6"	10	051	Red Spirea (var. Blue 10-14")	1" x 6"
10	047	Red Spirea	1" x 6"	10	052	Red Spirea (var. Blue 10-14")	1" x 6"
10	048	Red Spirea	1" x 6"	10	053	Red Spirea (var. Blue 10-14")	1" x 6"
10	049	Red Spirea	1" x 6"	10	054	Red Spirea (var. Blue 10-14")	1" x 6"
10	050	Red Spirea	1" x 6"	10	055	Red Spirea (var. Blue 10-14")	1" x 6"
10	051	Red Spirea	1" x 6"	10	056	Red Spirea (var. Blue 10-14")	1" x 6"
10	052	Red Spirea	1" x 6"	10	057	Red Spirea (var. Blue 10-14")	1" x 6"
10	053	Red Spirea	1" x 6"	10	058	Red Spirea (var. Blue 10-14")	1" x 6"
10	054	Red Spirea	1" x 6"	10	059	Red Spirea (var. Blue 10-14")	1" x 6"
10	055	Red Spirea	1" x 6"	10	060	Red Spirea (var. Blue 10-14")	1" x 6"
10	056	Red Spirea	1" x 6"	10	061	Red Spirea (var. Blue 10-14")	1" x 6"
10	057	Red Spirea	1" x 6"	10	062	Red Spirea (var. Blue 10-14")	1" x 6"
10	058	Red Spirea	1" x 6"	10	063	Red Spirea (var. Blue 10-14")	1" x 6"
10	059	Red Spirea	1" x 6"	10	064	Red Spirea (var. Blue 10-14")	1" x 6"
10	060	Red Spirea	1" x 6"	10	065	Red Spirea (var. Blue 10-14")	1" x 6"
10	061	Red Spirea	1" x 6"	10	066	Red Spirea (var. Blue 10-14")	1" x 6"
10	062	Red Spirea	1" x 6"	10	067	Red Spirea (var. Blue 10-14")	1" x 6"
10	063	Red Spirea	1" x 6"	10	068	Red Spirea (var. Blue 10-14")	1" x 6"
10	064	Red Spirea	1" x 6"	10	069	Red Spirea (var. Blue 10-14")	1" x 6"
10	065	Red Spirea	1" x 6"	10	070	Red Spirea (var. Blue 10-14")	1" x 6"
10	066	Red Spirea	1" x 6"	10	071	Red Spirea (var. Blue 10-14")	1" x 6"
10	067	Red Spirea	1" x 6"	10	072	Red Spirea (var. Blue 10-14")	1" x 6"
10	068	Red Spirea	1" x 6"	10	073	Red Spirea (var. Blue 10-14")	1" x 6"
10	069	Red Spirea	1" x 6"	10	074	Red Spirea (var. Blue 10-14")	1" x 6"
10	070	Red Spirea	1" x 6"	10	075	Red Spirea (var. Blue 10-14")	1" x 6"
10	071	Red Spirea	1" x 6"	10	076	Red Spirea (var. Blue 10-14")	1" x 6"
10	072	Red Spirea	1" x 6"	10	077	Red Spirea (var. Blue 10-14")	1" x 6"
10	073	Red Spirea	1" x 6"	10	078	Red Spirea (var. Blue 10-14")	1" x 6"
10	074	Red Spirea	1" x 6"	10	079	Red Spirea (var. Blue 10-14")	1" x 6"
10	075	Red Spirea	1" x 6"	10	080	Red Spirea (var. Blue 10-14")	1" x 6"
10	076	Red Spirea	1" x 6"	10	081	Red Spirea (var. Blue 10-14")	1" x 6"
10	077	Red Spirea	1" x 6"	10	082	Red Spirea (var. Blue 10-14")	1" x 6"
10	078	Red Spirea	1" x 6"	10	083	Red Spirea (var. Blue 10-14")	1" x 6"
10	079	Red Spirea	1" x 6"	10	084	Red Spirea (var. Blue 10-14")	1" x 6"
10	080	Red Spirea	1" x 6"	10	085	Red Spirea (var. Blue 10-14")	1" x 6"
10	081	Red Spirea	1" x 6"	10	086	Red Spirea (var. Blue 10-14")	1" x 6"
10	082	Red Spirea	1" x 6"	10	087	Red Spirea (var. Blue 10-14")	1" x 6"
10	083	Red Spirea	1" x 6"	10	088	Red Spirea (var. Blue 10-14")	1" x 6"
10	084	Red Spirea	1" x 6"	10	089	Red Spirea (var. Blue 10-14")	1" x 6"
10	085	Red Spirea	1" x 6"	10	090	Red Spirea (var. Blue 10-14")	1" x 6"
10	086	Red Spirea	1" x 6"	10	091	Red Spirea (var. Blue 10-14")	1" x 6"
10	087	Red Spirea	1" x 6"	10	092	Red Spirea (var. Blue 10-14")	1" x 6"
10	088	Red Spirea	1" x 6"	10	093	Red Spirea (var. Blue 10-14")	1" x 6"
10	089	Red Spirea	1" x 6"	10	094	Red Spirea (var. Blue 10-14")	1" x 6"
10	090	Red Spirea	1" x 6"	10	095	Red Spirea (var. Blue 10-14")	1" x 6"
10	091	Red Spirea	1" x 6"	10	096	Red Spirea (var. Blue 10-14")	1" x 6"
10	092	Red Spirea	1" x 6"	10	097	Red Spirea (var. Blue 10-14")	1" x 6"
10	093	Red Spirea	1" x 6"	10	098	Red Spirea (var. Blue 10-14")	1" x 6"
10	094	Red Spirea	1" x 6"	10	099	Red Spirea (var. Blue 10-14")	1" x 6"
10	095	Red Spirea	1" x 6"	10	100	Red Spirea (var. Blue 10-14")	1" x 6"

CITY OF MADISON
 LANDSCAPE PLANT REQUIREMENTS
 NUMBER OF PLANTS TO BE PLANTED
 NUMBER OF LANDSCAPE PLANTS REQUIRED

- GENERAL NOTES**
- 1) Areas labeled "See Note" shall require a minimum of 2" x 6" x 6" landscape mulch spread to a depth of 2" over the ground surface.
 - 2) Individual trees shall be planted in a minimum of 18" x 18" x 18" holes with a minimum of 18" of soil around the root ball. The hole shall be backfilled with a minimum of 2" of soil around the root ball.
 - 3) "See Note" shall require a minimum of 2" x 6" x 6" landscape mulch spread to a depth of 2" over the ground surface.
 - 4) "See Note" shall require a minimum of 2" x 6" x 6" landscape mulch spread to a depth of 2" over the ground surface.
 - 5) "See Note" shall require a minimum of 2" x 6" x 6" landscape mulch spread to a depth of 2" over the ground surface.
 - 6) "See Note" shall require a minimum of 2" x 6" x 6" landscape mulch spread to a depth of 2" over the ground surface.
 - 7) "See Note" shall require a minimum of 2" x 6" x 6" landscape mulch spread to a depth of 2" over the ground surface.
 - 8) "See Note" shall require a minimum of 2" x 6" x 6" landscape mulch spread to a depth of 2" over the ground surface.
 - 9) "See Note" shall require a minimum of 2" x 6" x 6" landscape mulch spread to a depth of 2" over the ground surface.
 - 10) "See Note" shall require a minimum of 2" x 6" x 6" landscape mulch spread to a depth of 2" over the ground surface.

1 Overall Landscape Plan
 SCALE: 1" = 50'-0"

ARNOLD AND SHERIDAN INC.
 ARCHITECTS INC.
 1100 East Washington Ave.
 Madison, WI 53703
 Phone: 608-255-2291 Fax: 608-255-2292

JGS
 ARCHITECTS INC.
 1100 East Washington Ave.
 Madison, WI 53703
 Phone: 608-255-2291 Fax: 608-255-2292

the cruce company
 LANDSCAPE ARCHITECTS
 LANDSCAPE CONTRACTORS
 100 N. MICHIGAN AVE.
 SUITE 400
 MADISON, WI 53703
 TEL: 608-255-1111
 FAX: 608-255-1112

**Hawk's Landing
 Lot 62
 Madison, Wisconsin**

DATE: 04-30-2003
 Revision: 7/29/03 Landscape Plan
 9/9/03 Landscape Plan

Drawing Name: Overall Landscape Plan

Project Number: 0218
 Sheet No.: L1.0



Retail/20 Unit Apartment Building

Front Elevation

HAWKS LANDING CIRCLE



Retail/20 Unit Apartment Building

Side Elevation

MIDTOWN ROAD



Jeff · Griebel · Principal
128 South Waterman Turn
Post Office Box 1091
Somers, WI 53182
Phone: 608.586.3071 Fax: 608.586.3149

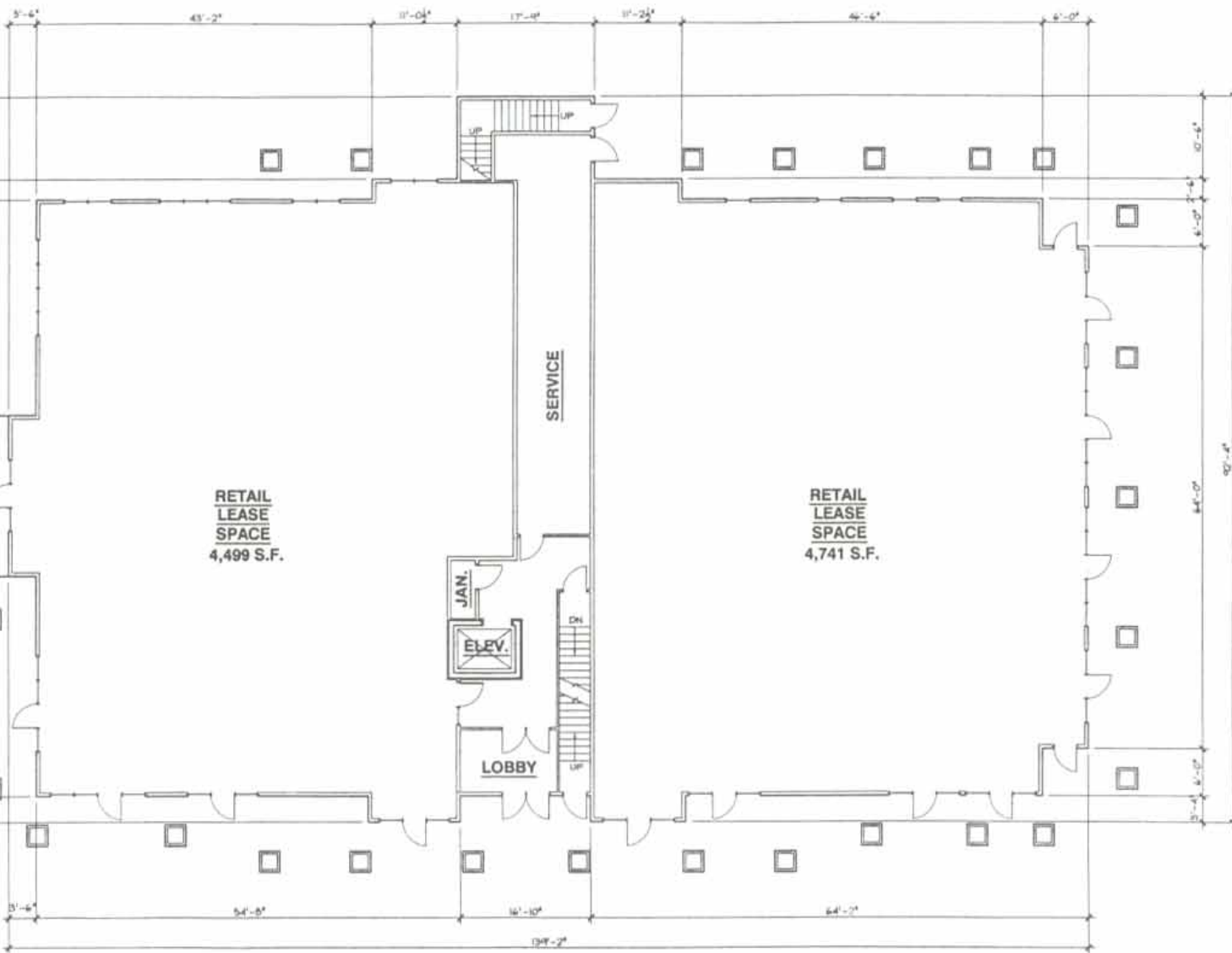

1
A1.0

FIRST FLOOR PLAN

BUILDING 'C' SHOWN
BUILDING 'D' SINK
SCALE: 1/8" = 1'-0"

FLOOR LEVEL S.F. (GROSS) = 10,677

**Hawk's Landing
Lot 62- Retail/20 Unit Apt. Bldg.
Madison, Wisconsin**

Date: 04-30-2003
Revisions:

THIS DOCUMENT, THE PLAN AND RELATED INSTRUMENTS ARE TO BE USED ONLY FOR THE PROJECT AND SITE SPECIFICALLY IDENTIFIED HEREIN. ANY OTHER USE OF THIS DOCUMENT IS PROHIBITED WITHOUT THE WRITTEN AUTHORIZATION OF GS ARCHITECTS, INC.

Drawing Name
First Floor Plan

Project Number: 0218C
Sheet No.: A1.0